

# PRECISION INSTRUMENT CORPORATION

## MODEL 'SE-102D', BACK CONNECTED GAUGE

AVAILABLE DIAL SIZES: 1 1/2", 2"

AVAILABLE CONNECTION SIZES:

1/8" MNPT ON 1 1/2" AND 2"

1/4" MNPT ON 2" AND 2 1/2"

### SPECIFICATIONS:

BLACK STEEL CASE WITH BLACK STEEL BEZEL

BRASS INTERNALS AND CONNECTION

GLASS LENS, DRY NON-FILLABLE

3-2-3 % ACCURACY

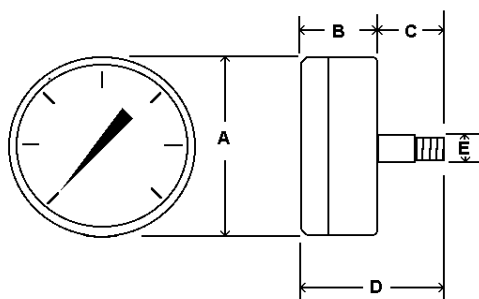

DIAL SIZE		A	B	C	D	E
1 1/2"	INCHES	1.64"	.93"	.63"	1.56"	1/8" NPT
	MM	42mm	24mm	16mm	39mm	1/8" NPT
2"	INCHES	2.07"	1.03"	.83"	1.86"	1/4" OR 1/8" NPT
	MM	53mm	26mm	21mm	47mm	1/4" OR 1/8" NPT
2 1/2"	INCHES	2.5"	1.17"	.86"	2.03"	1/4" MNPT
	MM	63mm	30mm	22mm	52mm	1/4" MNPT

### Part Number System

SE-102D - ?

#### Dial Size

15 = 1 1/2"

20 = 2"

25 = 2 1/2"

#### Connection Size

8 = 1/8" MNPT

4 = 1/4 MNPT

### Range Code

CODE	RANGE	MAJOR IN	MINOR IN
<b>C</b>	0/30 PSI	5 psi	.5 psi
With	2 Bar (x100 = kPa)	.5 bar	.05 bar
<b>D</b>	0/60 PSI	10 psi	1 psi
With	4 Bar (x100 = kPa)	1 bar	.1 bar
<b>E</b>	0/100 PSI	20 psi	.2 psi
With	7 Bar (x100 = kPa)	1 bar	.1 bar
<b>F</b>	0/160 PSI	20 psi	.2 psi
With	11 Bar (x100 = kPa)	2 bar	.2 bar
<b>G</b>	0/200 PSI	40 psi	5 psi
With	14 Bar (x100 = kPa)	2 bar	.2 bar
<b>H</b>	0/300 PSI	50 psi	5 psi
With	20 Bar (x100 = kPa)	5 bar	.5 bar