

PRECISION INSTRUMENT COMPANY

MODEL 'S219L', BACK FLANGED TRUCK MOUNT GAUGES

Our 'S219L' Gauge Is a Heavy Duty, High Quality Liquid Filled Gauge. The Glycerine Filling Helps Dampen The Effects Of Pulsation And Vibration, While Also Perpetually Lubricating The Movement (And Keeping Contaminates Such As Dirt Away From All Moving Parts) Which Will Extend The Life Of The Gauge.

Rugged Enough for the Trucking Industry, These Heavy Duty Gauges are designed to withstand abuse and extremes that are well in excess of what is normally seen in almost any other Commercial Or Industrial Applications. These gauges therefore are suitable for use in any application where process media

SPECIFICATIONS:

- **Dial Sizes:** 2 ½ & 4"
- **Connection Size:** 1/4" MNPT
- **Stainless Steel Case And Bezel**
- **Brass Internals & Connection (w/Internal Snubber)**
- **Phosphour Bronze Bourdon Tube**
- **Polycarbonate Lens**
- **Liquid Filled (Dry Available)**
- **Accuracy :** 2 ½" Dial Size = 1.5 %
4" Dial Size = 1 %
- **2 ½" Dial Size Dual Scale: PSI & Bar (x100=kPa)**
- **4" Dial Size Single Scale: PSI Only**
- **Ambient temperature:** FILLED: 30°F to 160°F
DRY: -30°F to 180°F



Part Numbers:

S219x-xxx x

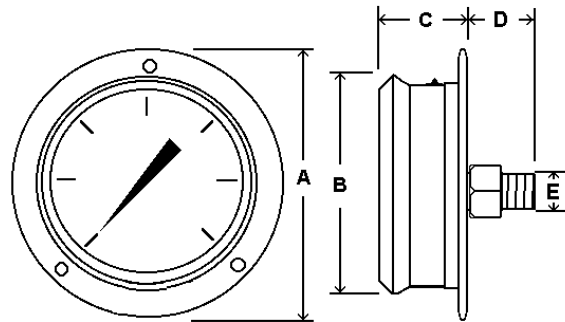
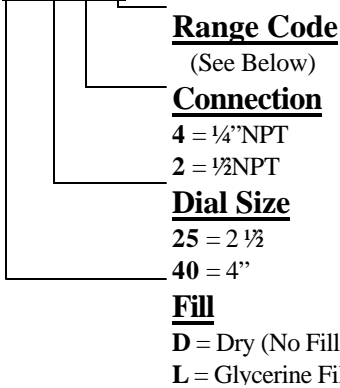

RANGE	CODE	Major In	Minor In
30/0" VAC	A	5	0.5
30/0/30	CC	10	1
0/30	C	5	0.5
0/100	E	20	2
0/160	F	20	2

		A	B	C	D	E
2 ½" Dial	In	3.41	2.8	1.33	1.18	¼ NPT
	MM	87	71	34	30	
4" Dial	In	5.2	4.32	1.7	1.14	¼ NPT
	MM	132	110	43	29	

Notes:

- Other Dial Sizes and Ranges are available.
- Other Connections Sizes and Configurations.
- Not all Dial Size / Range Combinations are in stock.

Please call to check stock