

PRECISION INSTRUMENT COMPANY

MODEL '302L', ALL STAINLESS BACK MOUNT

Our '300' Series Gauge Line Is A High Quality Line Of Stainless Steel Gauges. Hermetically Sealing The Gauge Prevents Dust, Dirt Or Other Contaminates From Entering The Case Of The Gauge And Attacking The Movement Or Internals Of The Gauge. Keeping Out Such Contaminates Prolongs The Life Of The Gauge.

This Gauge Has Been Specifically Designed With The Original Equipment Manufacturers In Mind And Are Typically Used In Chemical Processing or Food Processing Applications As Well As Any Commercial Or Industrial Application Where Stainless Steel Components are Required.

SPECIFICATIONS:

- Available Dial Sizes: 1 ½", 2", 2 ½", 3 ½", 4"
- Available Connection Sizes:
1/8"MNPT on 1 ½" and 2"
1/4"MNPT on 2", 2 ½", 3 ½" and 4"
- Stainless Steel Case And Bezel
- SS Internals & Connection
- 316SS Bourdon Tube
- Liquid Filled (Dry Available)
- Accuracy : Standard =2-1-2 % Per ANSI grade B
(Special Accuracy Available Upon Request)
- Dual Scale: PSI & Bar (x100=kPa)
Single Scale available from stock
- Ambient temperature: FILLED: 30°F to 160°F
DRY: -30°F to 180°F



RANGE	CODE	Major In	Minor In
30/0"VAC	A	5	0.5
30/0/15	CB	5	0.5
30/0/30	CC	10	1
30/0/60	CD	10	1
30/0/100	CE	20	2
30/0/150	CF	20	2
30/0/300	CH	50	10
0/15	B	2	0.2
0/30	C	5	0.5
0/60	D	10	1
0/100	E	20	2
0/160	F	20	2
0/200	G	40	5
0/300	H	50	5
0/400	I	50	5
0/600	K	100	10
0/1000	M	200	20
0/1500	N	200	20
0/2000	O	400	50
0/3000	P	500	50
0/5000	R	1000	100
0/10,000	U	1000	100
0/15,000	V	2000	200

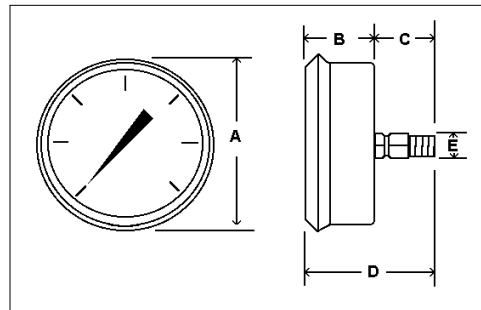

Note:

All Dial Size Gauges are Center Back Connection Except 3 ½" Dial Size which are Lower Back Connection

		A	B	C	D	E	F	G
1 ½"	In	1.88	1.06	.89	1.95	1/8"	2.63	1.63
	Dial MM	48	27	23	50	Npt	67	42
2"	In	2.23	1.09	.71	1.99	1/8" or	2.81	2.00
	Dial MM	57	28	23	51	¼"npt	72	51
2 ½"	In	2.80	1.28	1.19	2.46	1/4"	3.48	2.50
	Dial MM	71	33	30	63	Npt	88	64
3 ½"	In	3.83	1.14	1.08	2.20	1/4"	3.70	3.5
	Dial MM	97	29	27	56	Npt	94	89
4"	In	4.32	1.63	1.14	2.77	1/4"	5.20	3.87
	Dial MM	110	42	29	71	Npt	132	98